

FIG:  
**Z73** Knife Gate Valves



**Seat Types :**

**Metal To Metal**  
For applications with:  
High temperature  
High density media application  
When full tightness is not required

**Resilient Seat**  
Standard resilient seat.  
Temperature limitations according to seat material selected, Refer to the material selection sheet or contact with Hiwa directly for requested seat material. Replaceable seat retainer ring

**Resilient Seat With Reinforced Ring**  
Temperature limitations according to seat material selected, refer to the material selection sheet or contact with Hiwa directly for requested seat material. replaceable and reinforced seat ring available in different materials.

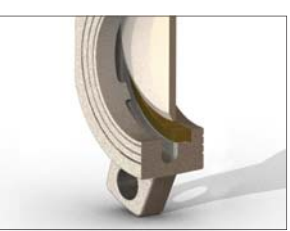

Metal Seat



Reinforced-Resilient Seat



Resilient Seat



**Manual Overview/ Automatic**



- ① Non-Rising Stem Hand Wheel Actuator
- ② Rising Stem Hand Wheel Actuator
- ③ Gear Box Actuator
- ④ Air Cylinder Actuator
- ⑤ Electric Actuator

**hiwa**  
**Huihua Valve Industry Co.**  
**Office:** 18<sup>th</sup> Floor, Block B International Trade Center  
107 Liuquan Road, Zibo City Shandong China P.C.:255000  
**ZiBo Factory :** No.36 MinAn Road New Hi-Tech  
Industry Zone Zibo Shangdong China PC.: 255088  
**Tianjin Factory:** No.2Yingye RD.,Huangtai  
Ind.,Park,Xiaozhan Town,Jinnan District Tianjin City China  
P.C.:300353  
**Tel:** 86 533 6077200 6077206  
**Fax:** 86 533 6077233 6077244  
**Web :** <http://www.hiwa.cn>  
**E-mail:** [sales@hiwa.cn](mailto:sales@hiwa.cn)

**Knife Gate Valves**



HUIHUA VALVE INDUSTRY CO.  
BIFINE(ZIBO)INT'L CO.,LTD



FIG:  
**Z73** Knife Gate Valves

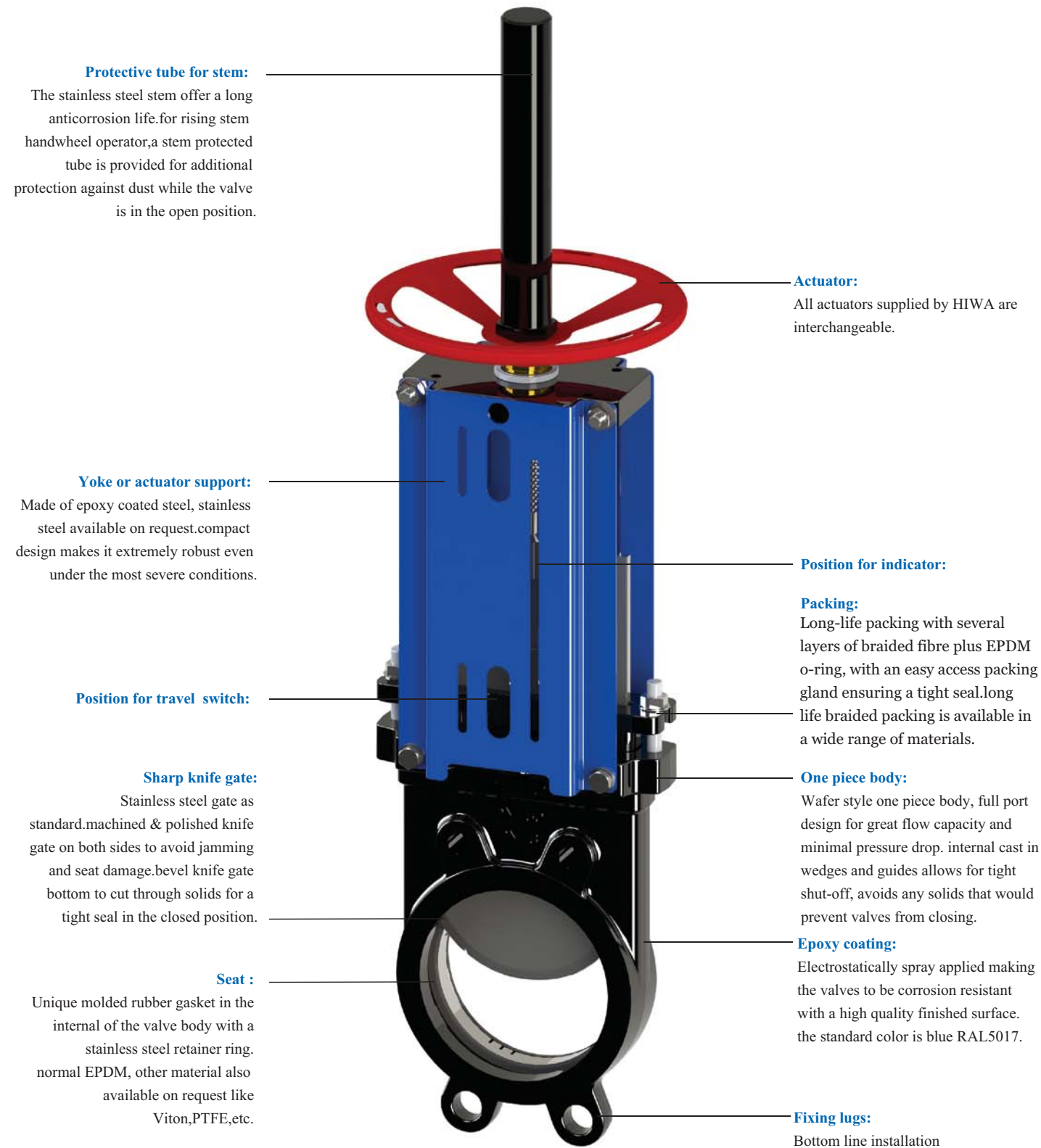

FIG:  
**Z73** Knife Gate Valves

◆ Application

- Pulp production
- Water, Waste water
- Treatment.
- Chemical industry
- Power plants
- Mining
- Etc.

Size Range: DN50 to DN600 ( Large Diameter Also Available on Request)

Working Pressure:  
10Bar for DN50 to DN250  
6Bar for DN300 to DN400  
5Bar for DN450  
4Bar for DN500 to DN600

End Flange Connection: EN1092 PN10 or ANSI B16.5 ( Class150)

Note: Other flange connections also available on request, kindly contact with Hiwa directly to check.

\*All Hiwa valves are tested according to the DIN3230; EN12266-2;iso5208 before shipping by our quality control department.

◆ Standard Material List

Item No.	Parts Name	Cast Iron	Stainless Steel
1	Body	CI/DI	WCB
2	Seat	Rubber	SS
3	Beat Back	SS	SS
4	Bolt	WCB	WCB
5	Washer	WCB	WCB
6	Yoke	WCB	WCB
7	Bushing	Bronze/Brass	Bronze/Brass
8	Bolt	WCB	WCB
9	Washer	WCB	WCB
10	Noze	Bronze/Brass	Bronze/Brass
11	Stuff	Rubber	Rubber
12	Washer	WCB	WCB
13	Nut	WCB	WCB
14	Gland	CI/DI	WCB
15	Stud	WCB	WCB
16	Washer	WCB	WCB
17	Nut	WCB	WCB
18	Knife Gate	SS	SS
19	Bolt	WCB	WCB
20	Nut	WCB	WCB
21	Stem Nut	Bronze/Brass	Bronze/Brass
22	Stem	WCB	WCB
23	Bushing	Bronze/Brass	Bronze/Brass
24	Top Flange	CI/DI	WCB
25	Handwheel	WCB	WCB

FIG :  
**Z73** Knife Gate Valves

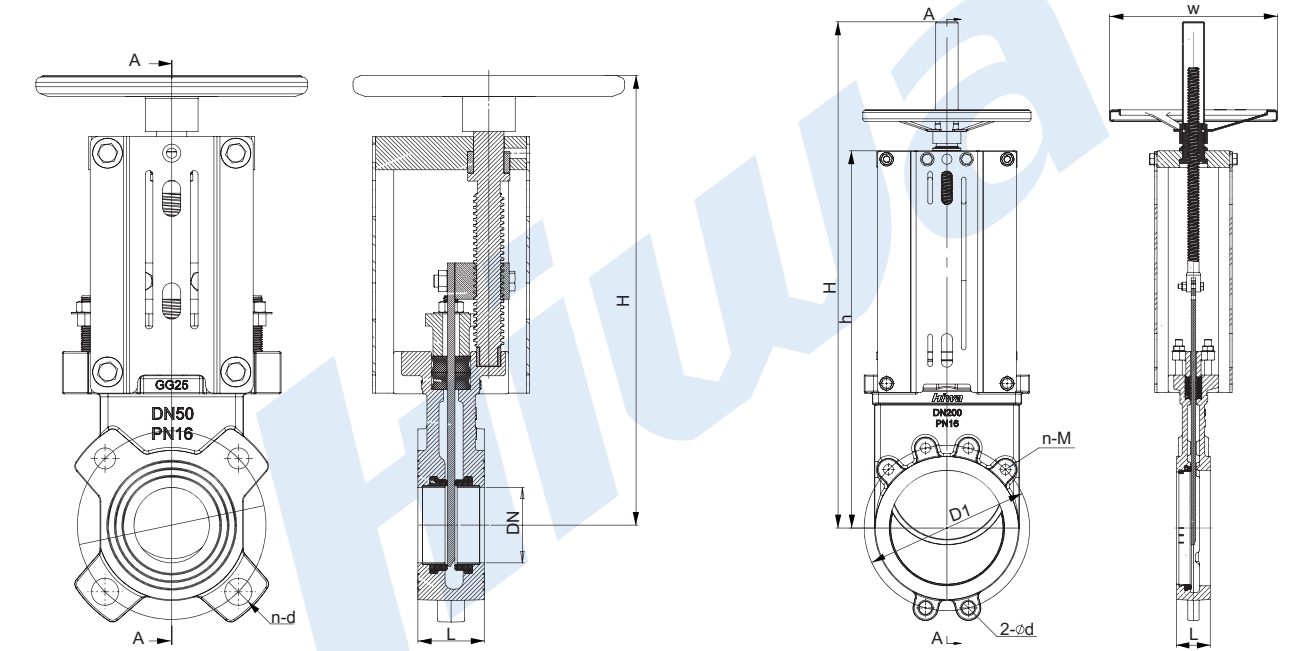
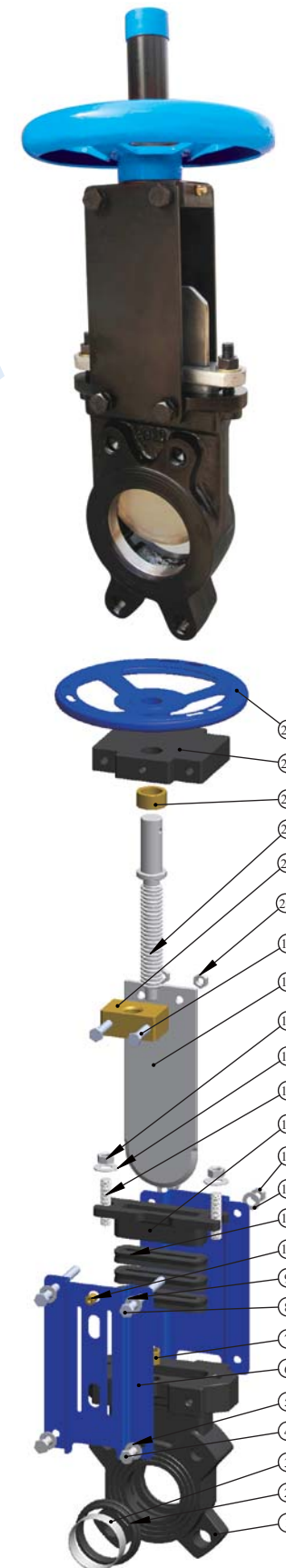

◆ Non-Rising Stem Hand Wheel

◆ Rising Stem Hand Wheel

◆ Dimensions/数据

Size	L	D1	n-d		
DN50	43	125	4-19	300	9
DN65	46	145	4-19	325	10
DN80	46	160	8-19	360	11
DN100	52	180	8-19	370	12
DN125	56	210	8-19	425	18
DN150	56	240	8-23	530	22
DN200	60	295	12-23	720	43
DN250	68	355	12-28	750	55
DN300	78	410	12-28	850	78

Size	L	D1	n-M					
DN50	43	125	2-M16	2-19	290	350	180	9.2
DN65	46	145	2-M16	2-19	312	390	180	10.2
DN80	46	160	2-M16	2-19	344	440	200	11.2
DN100	52	180	2-M16	2-19	350	470	200	12.2
DN125	56	210	2-M16	2-19	400	550	250	18.4
DN150	56	240	2-M20	2-23	500	680	250	22.5
DN200	60	295	4-M20	2-23	680	920	280	43.5
DN250	68	355	4-M24	2-28	700	1000	320	56
DN300	78	410	4-M24	2-28	790	1150	320	80

◆ Dimensions/数据

Size	D	SHORT STUD BOLT+NUT BLUE	LONG STUD BOLT+NUT RED
DN50	125	2-M16×60	2-M16×125
DN65	145	2-M16×60	2-M16×125
DN80	160	2-M16×60	6-M16×125
DN100	10	2-M16×60	6-M16×135
DN125	210	2-M16×60	6-M16×135
DN150	240	4-M20×60	6-M16×135
DN200	295	4-M20×65	8-M20×150
DN250	355	4-M20×65	8-M20×160
DN300	410	4-M20×65	8-M20×170

